

INSTALLATION INSTRUCTION

BirdShades bird protection window film

1. What to consider BEFORE installation

- Installation alignment: film width (1,37m) parallel to window width
- Side on which the window film will be applied:
The window film is designed for a transparent exterior float glass window

For other use cases please consider following:

- Apply the film on the side, which is approached by birds
- The film needs daylight, to ensure the effect in the UV-area

Please contact us when you consider using the window film for glass, which is not transparent, or glass which has special coatings on it or laminated glass (e.g. enameled glass) via: tweet@birdshades.com to make sure our bird protection window film works for the glass type

2. Tools for application

- Absorbent lint free towel
- Squeegee
- Glass scraper
- Cutter (new stainless-steel blade)
- Edge sealing tape or alternatively a suitable, neutral cross-linked silicone for edge sealing
- Pressure spray tank
- Application liquid (transfer liquid from BirdShades and clean water)

3. Weather conditions

- Temperature should not fall below 5° in the following 15 days (please also pay attention to the weather forecast!)
- Do not install when it rains and avoid direct sunlight on the substrate to be coated (pane must not be hot)
- Ideal application temperature is 15°-25°C
- Consider pollen flight/dust

4. Please note during installation

PET film with water-based self-adhesive coating

- Squeegee out water thoroughly and fast - otherwise permanent grey stains may appear.
- Do not touch the self-adhesive coating with your fingers (sensitive to pressure).
- Installation for large windows: Apply vertically with joint seams. Use the original edge of the window film (machine cut) to seam the film. Make sure that the seam joint is applied with a gap of 1-2 mm. Do not seal the seams of the film.

5. Installation instruction

1. Clean the window frame and any seals with a damp cloth. Then clean the window thoroughly with transfer liquid and glass scraper and after this continue with usual, conventional window cleaning using lamb skin leather cloth and squeegee. Make sure that the glass surface is free of residue and completely lint-free. Always clean with liquid.
2. Spray glass area where the window film is going to be applied or a window nearby (this also must be clean).
3. Put window film on the wet window nearby with the side of the releaseliner facing towards you – this is to avoid static charge.
4. Remove via adhesive tape the releaseliner and window film from each other. Lightly spray the window film while removing the releaseliner to avoid dust. Never touch the adhesive side of the film directly with your fingers.
5. Glass where window film will be applied: make sure glass area is clean and spray again
6. Position window film with adhesive side to glass.
7. Spray window film on the exterior with transfer liquid - always keep squeegee blade lubricated during squeegeeing – to avoid scratches.
8. Fix with the squeegee on the top of the film starting from the center to the left and right and then pull down vertically in the middle area (a "T" is formed, see Figure 1)

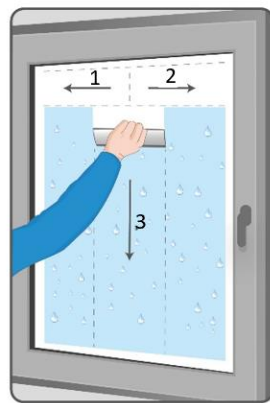

Figure 1: Creating a "T"

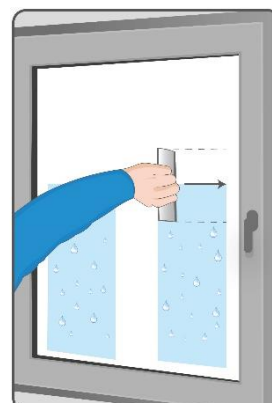

Figure 2: Overlap from center

9. When the film is correctly in place, quickly squeegee out the transfer fluid. Always wipe from center, slowly overlapping wipes moving downwards. Make sure that the moisture is squeegeed out quickly and thoroughly with sufficient pressure (see Figure 2).
The better the transfer liquid is squeegeed out, the more white coloring of the adhesive is prevented.
10. Wipe away any transfer liquid with an absorbent cloth and remove remaining transfer liquid within the window film by squeegeeing thoroughly with sufficient pressure.
11. At the end squeegee along the ends of the window film.
12. Remove remaining water with soft, lint-free cloth (NO microfiber cloth).

Edge sealing required for warranty reasons (suitable neutral cross-linked silicone or edge sealing tape), especially if moisture accumulation can occur, and when glass edges are exposed. Apply edge sealant when no residual liquid remains in the film.

For best results, we recommend BirdShades transfer liquid. If another product is used, it is the responsibility of the customer (or the installation company commissioned by the customer) to check whether this agent is suitable for the application (no streaking, transparency, etc.).

6. Care and cleaning instructions

Do not clean window film in the first 30 days after installation.

Cleaning agent must be wet and non-abrasive. Soft cleaning cloths (NO microfiber cloth), sponges or squeegees with lambswool are recommended for cleaning. Aggressive cleaning agents, abrasive materials, brushes, pointed objects or high-pressure cleaning are not suitable and can damage the window film. Regular cleaning recommended and is required for warranty reasons (cleaning interval in urban areas: 2 times per year, cleaning interval in rural areas: 1 time per year).

Status 07|2024 Technical information, data, recommendations, and other statements provided by BirdShades are based on information, tests, or experience which BirdShades believes to be reliable, but the accuracy or completeness of such information is not guaranteed. Such technical information and data are intended for persons with knowledge and technical skills sufficient to assess and apply their own informed judgment to the information. Many factors beyond BirdShades control and uniquely within user's knowledge and control can affect the use and performance of a BirdShades product in a particular application. Given the variety of factors that can affect the use and performance of a BirdShades product, the user is solely responsible for evaluating the BirdShades product and determining whether it is a fit for a particular purpose and suitable for the user's method of application.

Except where prohibited by law, BirdShades will not be liable for any loss or damage arising from a BirdShades product, neither direct, indirect, special, incidental or consequential, regardless of the legal theory asserted. Applicable laws and regulations as well as possible intellectual property rights must be observed. Product covered by various patent applications.

Subject to alterations

© BirdShades Innovations GmbH 2024